

Class 6/7 Torque Tool 40kNm Long & Short interface

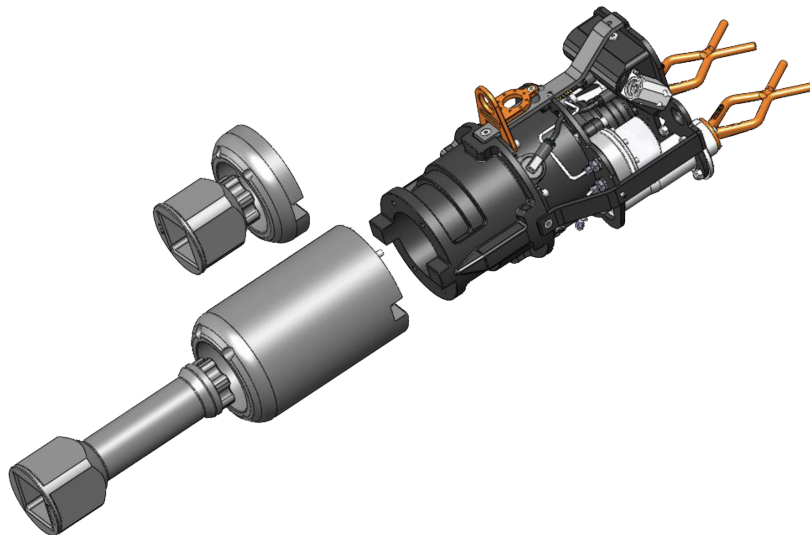

The tool is supplied with two versions interfaces, CL.7 long and short. The two interfaces are easily interchangeable and can be changed out in the field without the need to open the tool and refill the gear oil.

The Torque Tool is fitted with an electronic turn counter. Values displayed on an four digit display. Turns are counted to one decimal. The display can be directly connected to an Oceaneering RCU for the reading to be displayed on its control PC.

The TT is an ultra compact, lightweight and flexible torque tool to be used with most WROV Systems available. It is based on a 3-stage custom made oil filled Planetary Gear System directly connected to a hydraulic motor. The oil filled gear box is pressure compensated to ambient water pressure using a dedicated integrated pressure compensator.

Specifications

| | |
|---|---|
| Depth rating | 3000m |
| Hydraulic Oil Type for Turn conter housing | Tellus 22 or equivalent |
| Max hydraulic pressure | 210 bar / 3045 psi |
| Max hydraulic flow | 30 l/min |
| Minimum required flow | 5 l/min |
| Gear box oil | Q8 T65-LS/ Q8 T65-SAE 75W-90 or equivalent |
| Gear oil volume | approx. 5 litre |
| Hydraulic connections, Oil filling | JIC 4 male |
| Weight in air | CL. 7 LONG - 99KG CL. 7 SHORT - 88 KG |
| Weight in water | CL. 7 LONG - 68 KG CL. 7 SHORT - 65 KG |